

12' FENCES

ONE INTERMEDIATE RAIL WILL BE FURNISHED FOR ALL PANELS OF 8'-10' HIGH FENCES. TWO INTERMEDIATE RAILS WILL BE FURNISHED FOR ALL PANELS OF 12' HIGH FENCES. TOP AND BOTTOM RAILS WILL BE FURNISHED FOR ALL PANELS. FOR ALL FENCES, WHEREVER DIAGONAL BRACING CROSSES AN INTERMEDIATE RAIL, THE BRACE SHALL PASS BETWEEN THE RAIL AND THE MESH.

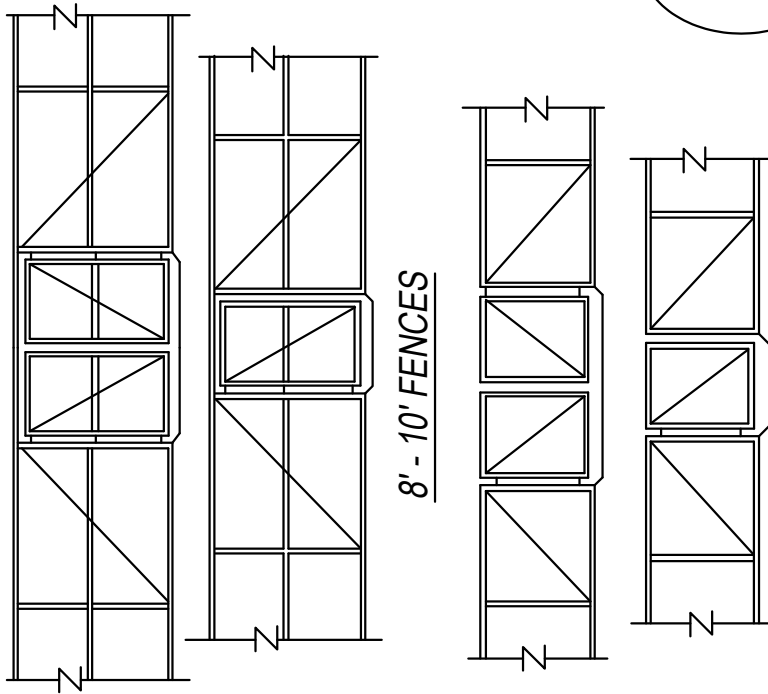

8' - 10' FENCES

3' - 6' FENCES



New York City Housing Authority  
 Capital Projects Division  
 Design Department  
 90 Church Street, 10th Floor  
 New York, NY 10007

Title:

**DIAGONAL BRACING  
 at Chain Link Gates**

Contract Name:

**GROUNDS REQUIREMENT**

Contract No.

**GD XXXXXXX**

Drawn by:  
 G. SOUKAS

Checked by:  
 K. MARSHAL

Scale:

**Not to Scale**

Date:

**January 2017**

Drawing No.

**CLF- 04**