

1 BRICK MASONRY REPLACEMENT AT SOLID WALL
SCALE: N.T.S.

REPAIR STEPS:

1. SHORE AND PROTECT EXISTING BRICKWORK TO REMAIN
2. REMOVE THE DAMAGED BRICKS CAREFULLY BY SAW CUTTING THE JOINTS, WITHOUT DAMAGING ADJACENT SOUND CRICKS.
3. HEADER COURSES SHALL REMAIN IN PLACE WHERE NOT DAMAGED.
4. VERIFY THAT SUBSTRATE IS IN GOOD CONDITION. REPAIR AS REQUIRED.
5. PARGE INTERIOR BLOCK WYTHE MORTAR.
6. REPLACE DAMAGED FLASHING WITH NEW FLASHING AND MASTIC CEMENT WHERE APPLICABLE.
7. PRE-WET BOTH NEW AND SURROUNDING BRICKS BEFORE LAYING, BUT THEY SHALL NOT BE WET AT THE TIME OF LAYING. THOROUGHLY WET THE ABUTTING BRICK SURFACES.
8. THE NEW BRICKWORK TO THE BACK-UP WALLS AND COLUMNS WITH BRICK TIES AND ANCHORS, AND TOOTH INTO THE EXISTING BRICKWORK. REPLACE EXISTING WEEPHOLES WITH NEW WEEPHOLES WHERE APPLICABLE.

PROVIDE TEMPORARY SHORING AND PIPE SCAFFOLDING AS REQUIRED. CONTRACTOR TO PROVIDE TEMPORARY SHORING DRAWINGS AND CALCULATIONS SIGNED AND SEALED BY A PROFESSIONAL ENGINEER LICENSED IN THE STATE OF NEW YORK.

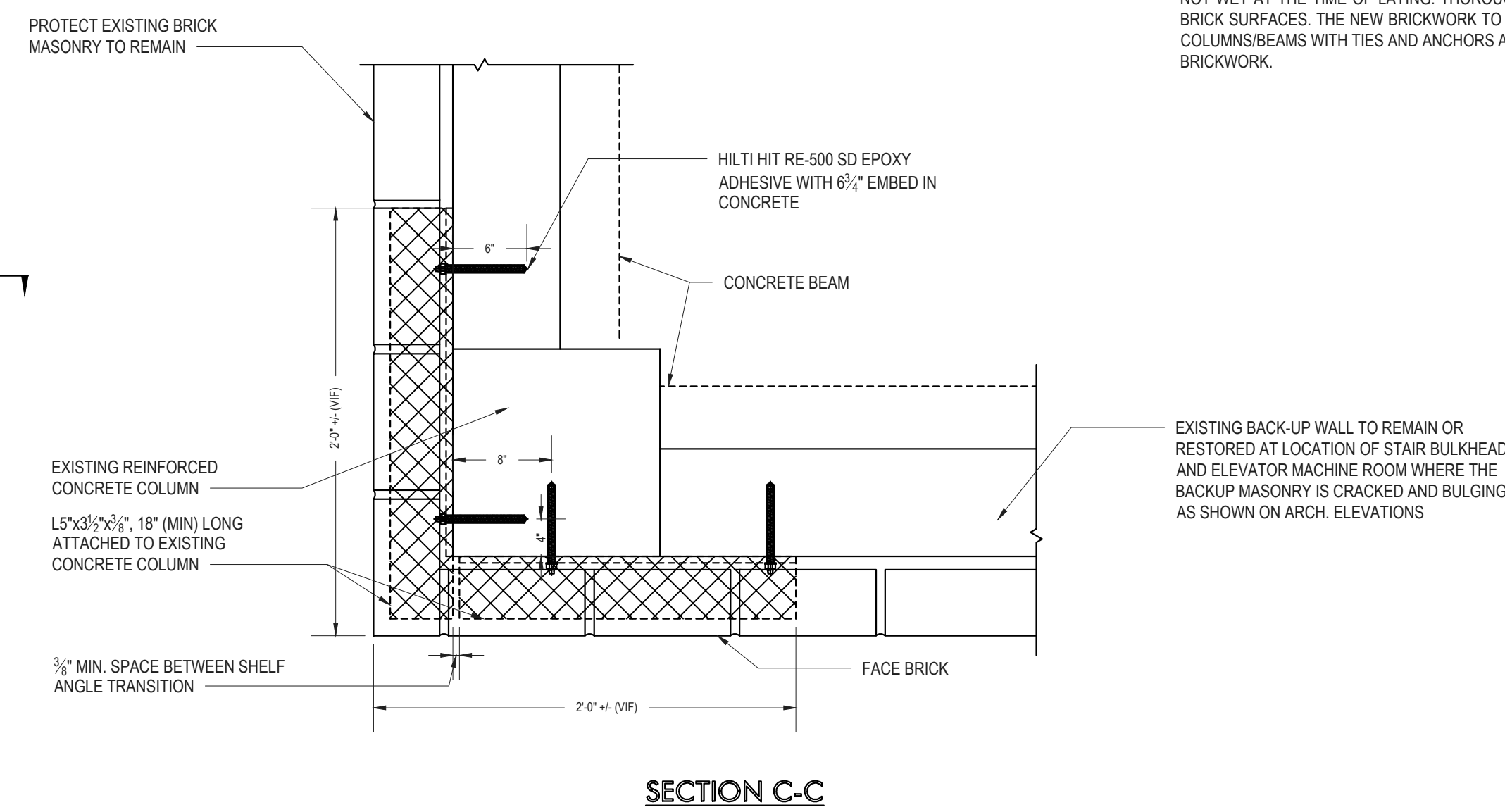
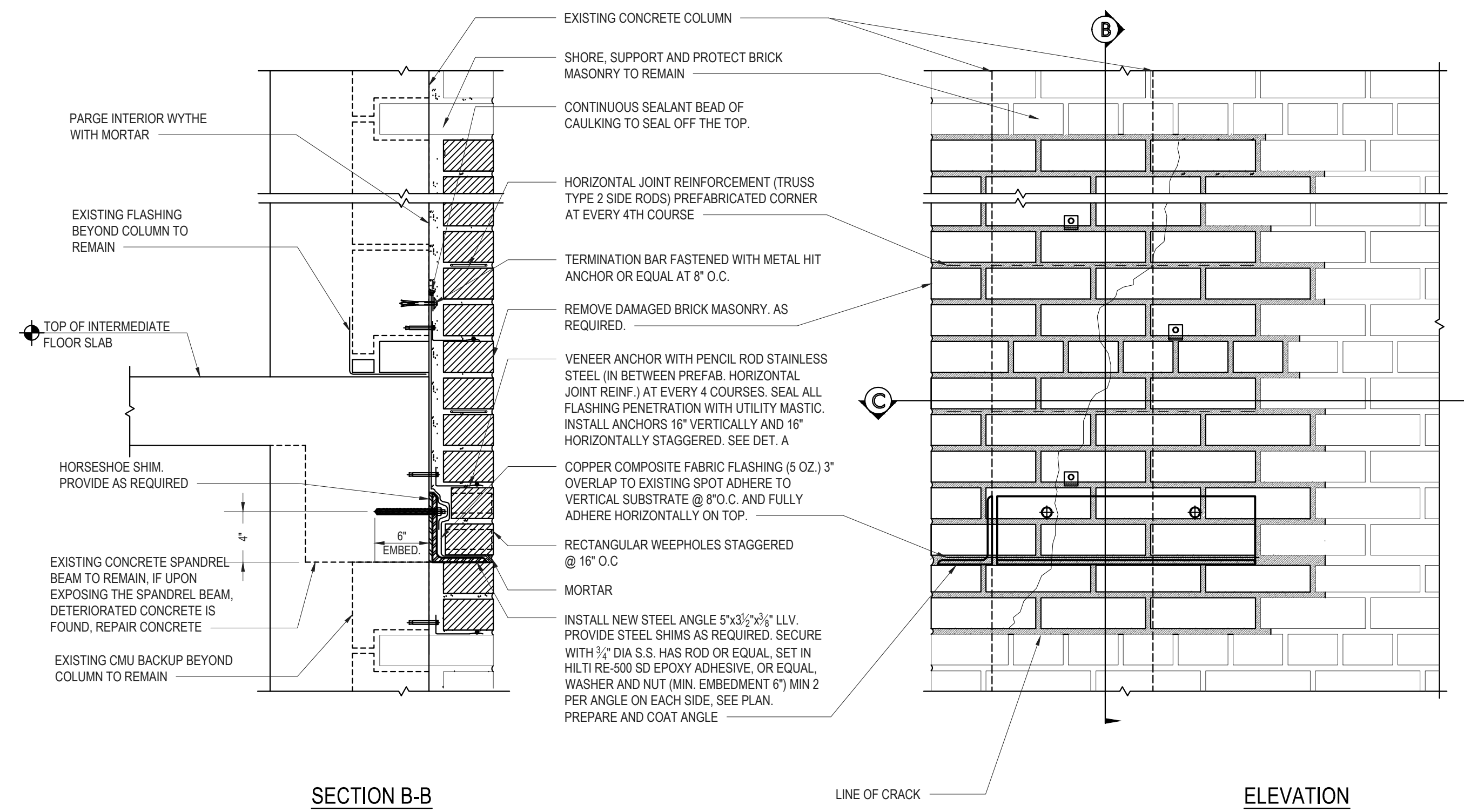
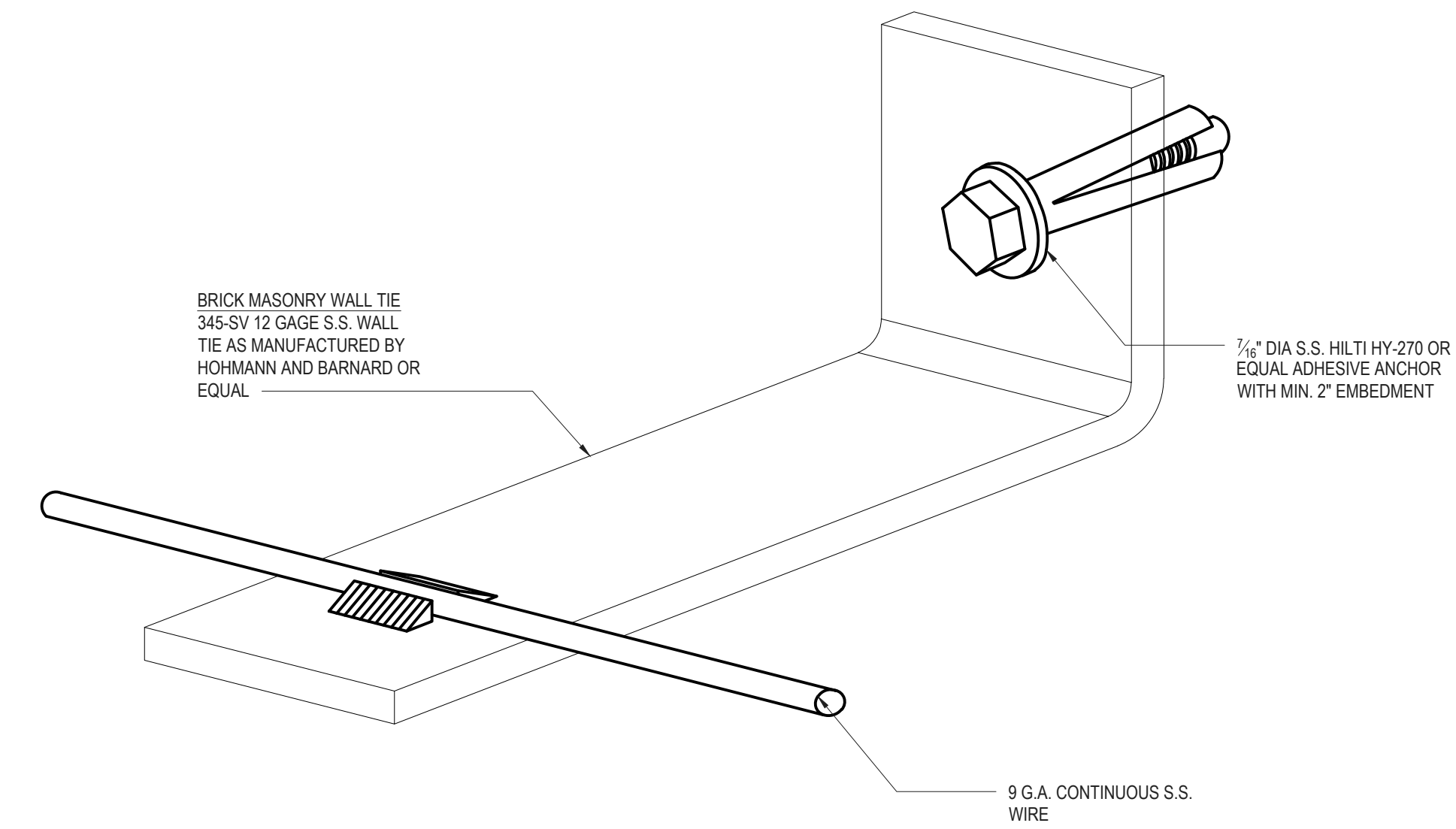

REPAIR STEPS:

1. REMOVE THE REQUIRED BRICKWORK BY SAW CUTTING THE JOINTS WITHOUT DAMAGING ADJACENT SOUND BRICKS.
2. CONTRACTOR TO PROVIDE TEMPORARY SHORING.
3. PROVIDE SHORING AS REQUIRED. VERIFY THAT SUBSTRATE IS IN GOOD CONDITION. REPAIR AS REQUIRED.
4. PARGE INTERIOR BLOCK WYTHE WITH MORTAR.
5. PROVIDE NEW GALVANIZED ANGLE CONNECT TO CONCRETE COLUMN AND SPANDREL WITH STAINLESS STEEL ANCHORS AS NECESSARY.
6. INSTALL NEW COPPER COMPOSITE FABRIC FLASHING
7. PROVIDE MASONRY ANCHORS AND JOINT REINFORCEMENT AS SHOWN.
8. PRE-WET BOTH NEW AND SURROUNDING BRICKS BEFORE LAYING, BUT NOT WET AT THE TIME OF LAYING. THOROUGHLY WET THE ABUTTING BRICK SURFACES. THE NEW BRICKWORK TO THE BACK-UP WALLS AND COLUMNS/BEAMS WITH TIES AND ANCHORS AND TOOTH INTO EXISTING BRICKWORK.

BRICK REPLACEMENT

A CORNER RESTORATION AT SOLID WALL (AT CONCRETE COLUMN LOCATION)
SCALE: N.T.S.

A.C.

S-003.00

25