

STEP 1:
MORTAR REMOVAL, CIRCULAR GRINDER REMOVAL METHOD (ELECTRIC GRINDERS MAY BE USED ONLY ON LARGE, HORIZONTAL JOINTS)

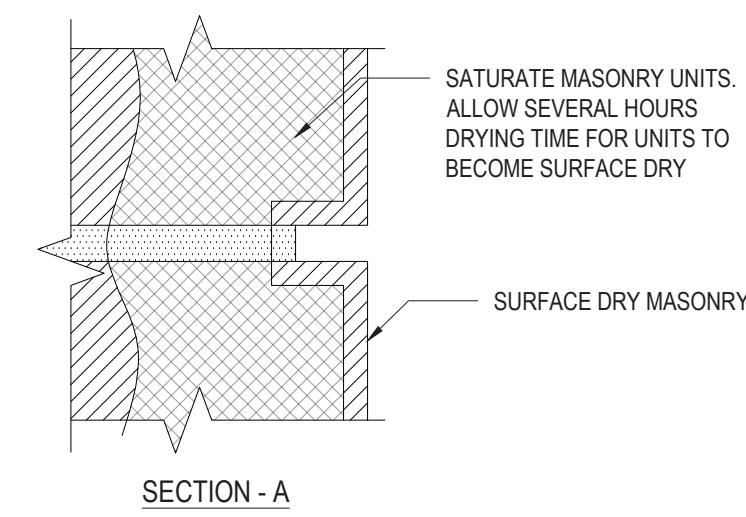

STEP 2: PRE-WETTING OF MASONRY UNITS

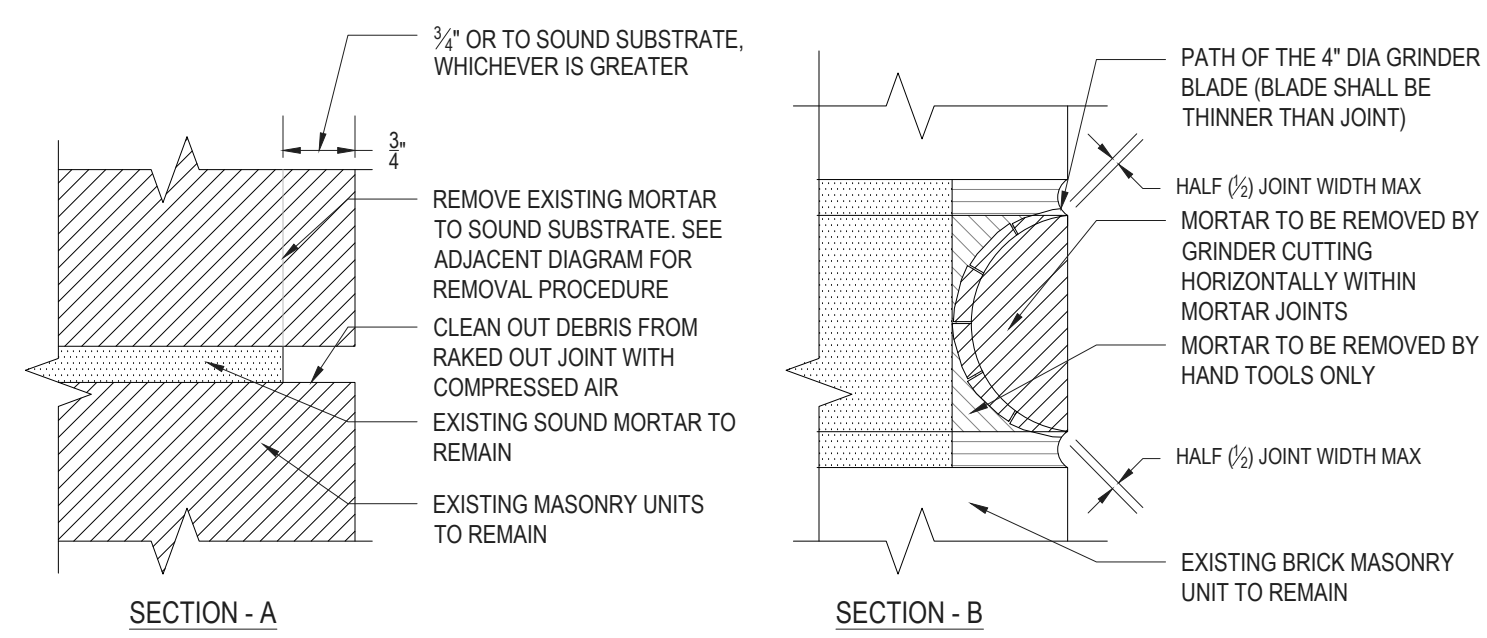
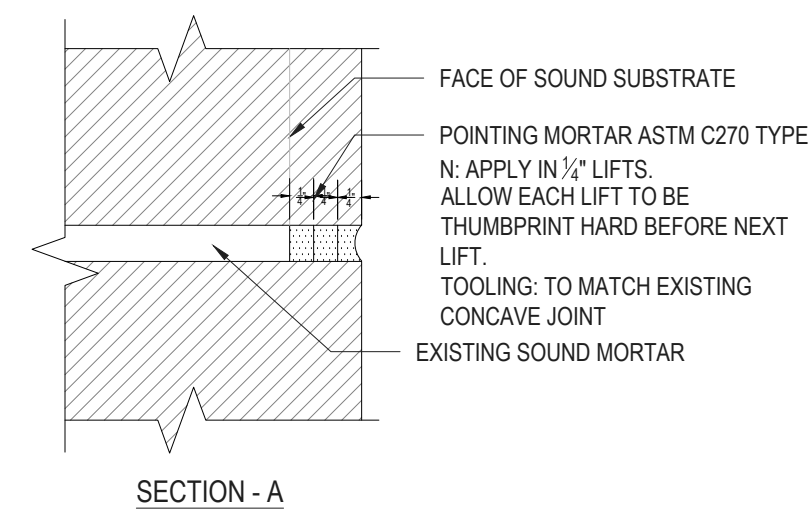

STEP 3: APPLICATION OF MORTAR

REPAIR PROCEDURE

1. VERTICAL JOINTS ARE TO BE RAKED BY HAND WITHOUT POWER TOOLS.
2. ELECTRIC GRINDERS MAY BE USED ONLY ON LARGE, HORIZONTAL JOINTS.
3. CARE MUST BE TAKEN NOT TO CHIP THE EDGES OF THE BRICKS OR ENLARGE THE ORIGINAL SPACING BETWEEN THEM.
4. SPECIAL CARE MUST BE TAKEN NOT TO CHIP THE EDGES OF THE BRICKS OR ENLARGE THE ORIGINAL SPACING BETWEEN THEM.
5. SAW CUT JOINTS UNTIL SOUND MATERIAL IS REACHED OR A MINIMUM 3/4" DEEP WHICHEVER IS GREATER. USE ONLY HEPA VACUUM ATTACHED SAW.
6. THOROUGHLY CLEAN AND BRUSH OUT RECESSES AND REMOVE ALL OLD MORTAR, CAULKING, AND FOREIGN AND LOOSE MATERIAL.
7. DO NOT DAMAGE BRICKS DURING MORTAR REMOVAL.
8. RINSE BRICK JOINT SURFACES WITH WATER TO REMOVE ANY DUST AND MORTAR PARTICLE. THERE SHALL BE NO EXCESS WATER AT THE TIME OF RE-POINTING AND JOINT SURFACES ARE DAMP BUT FREE OF STANDING WATER WHILE JOINTS ARE STILL MOIST. FILL THE ENTIRE WIDTH OF THE JOINTS WITH MORTAR, INCLUDING THE AREA OF THE JUNCTION BETWEEN THE ORIGINAL MORTAR AND BRICK. SEVERAL LAYERS WILL BE REQUIRED TO FILL THE JOINT FLUSH WITH THE OUTER SURFACE OF THE MASONRY. APPLY IN LAYERS NOT GREATER THAN 1/4" UNTIL A UNIFORM DEPTH IS FORMED.
9. WHEN THE FINAL LAYER OF MORTAR IS THUMB PRINT HARD, TOOL THE JOINT IN A MANNER TO MATCH THE APPEARANCE OF THE EXISTING MORTAR IN COLOR, TEXTURE AND SHAPE.
10. CLEAN BRICKWORK OF ALL FEATHER EDGING AND EXCESS MORTAR.
11. ALL JOINTS SHALL BE COMPACTED AND TOOLED WHILE MOIST TO OBTAIN A CONCLAVE SURFACE.
12. CURE MORTAR BY MAINTAINING IN A DAMP CONDITION FOR NOT LESS THAN 72 HOURS.
13. ALL AFFECTED ACM SHALL BE REMOVED AS PER ASBESTOS ABATEMENT PROCEDURES.
14. THE CONTRACTOR SHALL RE-POINT EXISTING MORTAR JOINTS * WIDTH * TO MATCH, AT NO ADDITIONAL COST TO NYCHA.

BRICK RE-POINTING